

Fittings programme

ETK

ETW



Shower and bath meter



Wash-basin meter



6 complete solutions with our universal single-jet meter with overall lengths 60 or 80 mm



Tap meter



Flush-mounted meter



Valve meter



Wash-basin meters

WET-

Assembly dimensions:

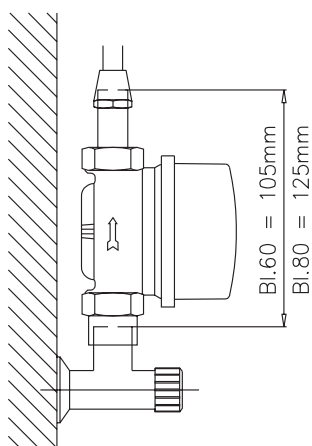

For installation between corner valve $\frac{3}{8}$ " and copper pipe dia. 10 mm.

Flexible hoses are usually unnecessary.

The complete wash-basin meter consists of:

Meter set

certified single-jet meter incl. assembly kit:
connector for the corner valve and of the
compression fitting for the copper pipe

The replacement set consists of:

meter, 2 rubber seals and 2 O-rings

Tap meters

ZET-

Assembly dimensions:

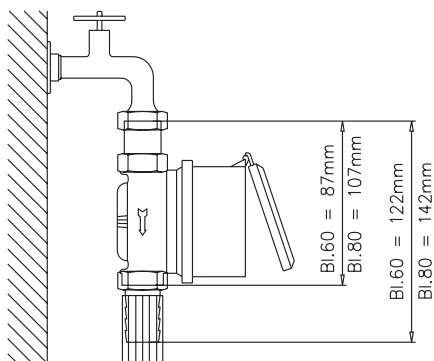

For subsequent attachment to hose connections, e.g. in the garden, on washing mashines or on building sites.

In certain federal states, when the tap meter is used as a garden meter you can reduce your water costs by the quantity which has been used in the garden if a certain minimum quantity (usually 60 m³ p.a.) has been consumed.

Ask your water supplier.

The complete tap meter consists of:

Meter set

certified single-jet meter incl. assembly kit:
protective cover, $\frac{1}{2}$ " hose connector and
 $\frac{3}{4}$ " union nut, fits $\frac{1}{2}$ " tap valves

The valve meters are notable for their compact construction and are therefore easy to install even in the confined space between two valves which are set in the wall. The function of the original valve is maintained with the new valve that is incorporated in the assembly.

The seals on the completed assembly are fully tested.

The complete valve meter set consists of 2 supply units which must be ordered separately:

- 1. Meter set**
certified single-jet meter with installation kit, without connection piece
- 2. VET connection piece**
Standard connection piece 40 mm, in the case of valves set deep in the wall the connection piece is available in lengths 60, 80 or 100 mm (special lengths by request)

The replacement set consists of:

meter, 2 rubber seals and 2 O-rings



Assembly dimensions:

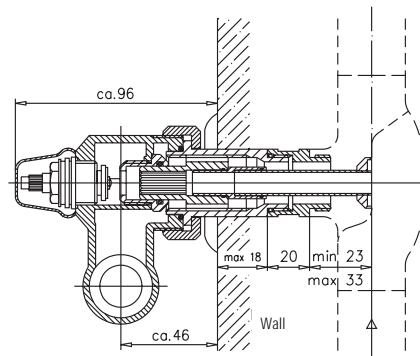

Valve meters

VET-

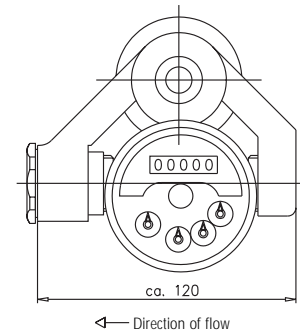

Valve meters were designed for subsequent installation in pipes laid beneath the wall surface.

Their compact construction allows them to be fitted in the most confined spaces. The shut-off function is maintained by the integrated valve.

The valve meters are suitable for stop valves conforming to DIN 3512.



The complete valve meter set, type W, consists of 2 units which must be ordered separately:

- 1. Meter set**
certified single-jet meter with installation kit, without connection piece
- 2. VET-W installation set**
flow pipe, seal support, O-ring, 2 seals, sealing ring, locking wire, self-locking seal, extension / reducing adaptor

Length	1/2"	A	mm	22-28
	3/4"			25-31
	1"			31-37
	1/2"	A+B	mm	26-100
	3/4"			25-103
	1"			38-109
		C	mm	max. 182
Height		D	mm	148
Width		E	mm	ø 65

Valve meter

VET-W

Assembly dimensions:

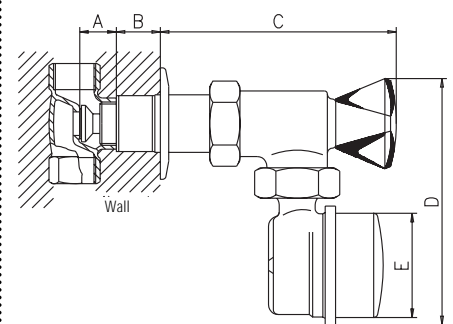

Shower and bath meters

DWET-

Assembly dimension:

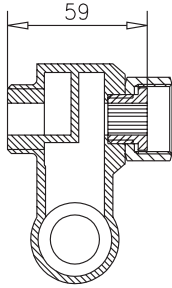

For subsequent installation between the mixing chamber and the supply.

Special adaptor piece available if only one meter is to be installed.

The complete shower and bath meter consists of:

Meter set

1 certified single-jet meter with installation kit

Flush-mounted meters

UET-



Robust, rust-proof sheet-steel flush box with built-in adaptor piece. Access to the connectors on the meter is achieved by removing the rosette. With the use of the adaptor rings it is possible to bridge every required distance between the meter and the rosette. Easy installation and removal with the use of two movable union nuts.

The complete flush-mounted meter set consists of 2 units which must be ordered separately:

1. Meter set

certified single-jet meter, chrome-plated rosette and 3 spacer rings

2. UET installation kit

flush box with built-in adaptor piece and mounting block

The replacement set consists of:

meter, 2 fibre seals ½" and 2 O-rings for the sliding piece

Assembly dimensions in mm:

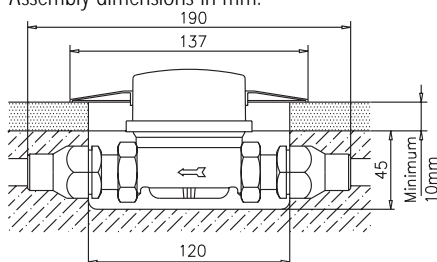

In developing this product, our primary concern were the problems faced by the plumber during the installation.

The installation of the manifold body and the mounting of the measuring capsule has been designed to be as quick and easy as possible. The flush-fitting aid serves at the same time as the assembly key.

When the adaptor rings are fitted, the depth of the connection in the wall is not important.

The body can be sealed with the supplied pressure plate so as to enable the pipeline system to be used before the measuring capsule is inserted. The measuring capsule can be subsequently fitted or replaced when required.

The meters are single-jet dry dial meters which of course have EC type approval. If you wish, you can also use the meters without the rosette as surface-mounted meters.

The counter face can be rotated and can be supplied with either a 5 or an 8-digit roller counter as required.



Possible manifold body connections:
 EAT 1/2" (male thread), 15 mm soldered joint
 EAT 3/4" (male thread), 18 mm soldered joint
 EAT 22 mm soldered joint
 EAT 3/4" (female thread)

Overall length 110 mm
 Height 73 mm
 Diameter 84 mm
 Weight 0,95 kg

Capsule meters

NEPTUN flush-mounted meters



The meter is also available as a pulse output version with the following pulse value as standard:
 100 l/pulse
 (others by request)

Class

D87
 6.131.23

H: A+B
 V: A

Class

D86
 6.331.72

H: A+B
 V: A

European approvals

The complete capsule meter set consists of 2 units which must be ordered separately:

- Meter set**
certified measuring capsule with chrome-plated rosette, chrome-plated protective sleeve and 3 spacer rings
- NEPTUN installation kit**
body (EAT) with locking ring, cover seal, O-ring and flush-fitting aid

The replacement set consists of:

Measuring capsule, 1 locking ring incl. plastic ring and 1 O-ring

Assembly dimensions in mm:

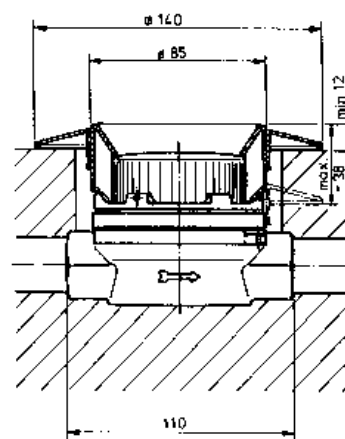

Coaxial measuring cartridges

Mithrasmeter
Qn 1.5



The well thought-out, flexible modular system

- **secure initial installation and quick replacement**
- can be fitted **in confined spaces**
- compatible with existing systems
- ISTA key for installation can be used
- **easy installation** of the measuring cartridge
- high stability of measurement due to high-quality sapphire bearing of the turbine
- **readings possible in any position** due to rotatable 8-roller counter
- chrome-plated cover for flush-fitting installations
- installed ISTA metal rosettes can be used

Measuring cartridge N
for low body (EAS / N)

The complete coaxial meter set EAS / N consists of 3 units which must be ordered separately:

- 1. Meter set**
certified measuring cartridge N with profile seal and locking set
- 2. Installation kit**
low body (EAS / N), cover seal, seal and flush-fitting aid

Possible manifold body connections:
EAS 1/2" (male thread), 15 mm soldered joint
EAS 3/4" (male thread), 18 mm soldered joint
EAS 22 mm soldered joint
EAS 3/4" (female thread)

- 3. Rosette**



Mithras measuring cartridge N



with EAS connection piece



with rosette (ROS-MESSP) as flush-fitting meter



with rosette (ROS-CR) and spacer ring (E-ZRUPZ) as flush-fitting meter (see ordering data NEPTUN series)

- A complete coaxial meter with high EAS body is available on request. Ask for details.

European approvals

MKK

Class

MKW

Class

D96
6.131.95

H: A+B
V: A

D96
6.331.75

H: A+B
V: A

Meter ordering data

Scope of supply:



Meter

Assembly set



Meter

Assembly set



Meter set



VET connector piece
(special lengths on request)



Meter set



VET-W installation set



Mithras measuring cartridge N



Rosette



Installation set



Flush-fitting aid



Meter set



Adaptor piece

Model	Nominal size m ³ /h	Connection	Overall length	Type	Order No.
Meter set WETK incl. installation set	Qn 1.5	1/2"	60 mm	WETK3060	14E 001
		1/2"	80 mm	WETK3080	14E 002
Meter set WETW incl. installation set	Qn 1.5	1/2"	60 mm	WETW3060	14E 003
		1/2"	80 mm	WETW3080	14E 004
Installation set single		1/2"		SWET	65E 001
Replacement set WETK *	Qn 1.5	1/2"	80 mm	SWETK80-AT	65E 032
Meter set ZETK incl. installation set	Qn 1.5	1/2"	60mm	ZETK060	15E 001
		1/2"	80 mm	ZETK080	15E 002
Installation set single		3/4"		SZET	65E 002
Meter set VETK Meter with installation kit without connection piece	Qn 1.5	1/2"	60 mm	VETK060-1/2	16E 001
		1/2"	80 mm	VETK080-1/2	16E 002
Meter set VETW Meter with installation kit without connection piece	Qn 1.5	1/2"	60 mm	VETW060-1/2	16E 003
		1/2"	80 mm	VETW080-1/2	16E 004
VET connection piece		1/2"	40 mm	SVETV040-1/2	65E 003
		3/4"	40 mm	SVETV040-3/4	65E 004
		1"	40 mm	SVETV040-1	65E 005
Replacement set VETK *	Qn 1.5	1/2"	80 mm	SVETK80-AT	65E 046
Meter set VETK-W without installation set	Qn 1.5			VETK1.5-W	16E 005
Meter set VETW-W without installation set	Qn 1.5			VETW1.5-W	16E 006
VET-W Installation set		1/2"		MZSV-1/2-W	65E 006
		3/4"		MZSV-3/4-W	65E 007
		1"		MZSV-1-W	65E 008
Meter set, cold measuring cartridge N	Qn 1.5			MESSPN-K	19E 001
Meter set, warm measuring cartridge N	Qn 1.5			MESSPN-W	19E 002
Installation set EAS / N low body		1/2"/15 mm solder		EASN-SET1-15	65E 042
		3/4"/18 mm solder		EASN-SET1-18	65E 043
		3/4" female thread		EASN-SET1-IG	65E 044
		22 mm solder		EASN-SET1-22	65E 045
Rosette				ROS-MESSP	65E 011
Sealing and locking set				EASN-PS	65E 012
DWETK, 1 meter with installation kit, cold	Qn 1.5	1/2"	60 mm	DWETK060	17E 001
		1/2"	80 mm	DWETK080	17E 002
DWETK, 1 meter with installation kit, warm	Qn 1.5	1/2"	60 mm	DWETW060	17E 003
		1/2"	80 mm	DWETW080	17E 004
Adapter piece		3/4"	55 mm (assembly dimension)	SDWA060	65E 013

* Meter in replacement set also available as hot water model and in overall length 60 mm

Meter ordering data

Scope of supply:



Meter set



UET installation set



Meter set



Assembly key and NEPTUN installation set



Model	Nominal size m ³ /h	Connection	Overall length	Type	Order No.	
Meter set UET cold	Qn 1.5		60 mm	EETK3060	18E 001	
			80 mm	EETK3080	18E 002	
Meter set UET warm	Qn 1.5		60 mm	EETW3060	18E 003	
			80 mm	EETW3080	18E 004	
UET installation set			½"/15 mm solder	for 60 mm	EPKA006015	65E 014
			¾"/18 mm solder	for 60 mm	EPKA006018	65E 015
			22 mm solder	for 60 mm	EPKA006022	65E 016
			½"/15 mm solder	for 80 mm	EPKA008015	65E 017
			¾"/18 mm solder	for 80 mm	EPKA008018	65E 018
			22 mm solder	for 80 mm	EPKA008022	65E 019
Spacer ring				E-ZRUPZ	55E 001	
Rosette gloss chrome-plated				RUPZCR	65E 020	
Rosette matt chrome-plated				RUPZCRM	65E 021	
Rosette RAL colours				RUPZRAL	65E 022	
Replace. set for UETK *	Qn 1.5		80 mm	SUETK80-AT	65E 033	
Meter set NEPTUN cold	Qn 1.5			MESS-UPZ-K	19E 003	
Meter set NEPTUN warm	Qn 1.5			MESS-UPZ-W	19E 004	
NEPTUN installation set incl. assembly key			½"/15 mm solder		GEH-UPZ15	65E 023
			¾"/18 mm solder		GEH-UPZ18	65E 024
			22 mm solder		GEH-UPZ22	65E 025
			¾" (fem. thread)		GEH-UPZ-IG	65E 026
Meas. capsule NEPTUN cold	Qn 1.5			EUPZ-K	19E 005	
Meas. capsule NEPTUN warm	Qn 1.5			EUPZ-W	19E 006	
Spacer ring				E-ZRUPZ	55E 001	
Rosette gloss chrome-plated				ROS-CR	65E 027	
Rosette RAL colours				ROS-RAL	65E 028	
Protective sleeve gloss chrome-plated				CYL-CR	65E 029	
Protective sleeve RAL colours				CYL-RAL	65E 030	
Assembly key				NEP-SCHL	65E 031	
Replace. set for NEPTUN cold	Qn 1.5			NEPTUN-K-AT	65E 034	
Replace. set for NEPTUN warm	Qn 1.5			NEPTUN-W-AT	65E 047	

* Meter in replacement set also available as hot-water model and in overall length 60 mm